

DYNAMIC SOLUTIONS

FOR ROLL UP DOORS

- Fire and Emergency Vehicles
- Service Vehicles and Trailers
- Commercial and Industrial Enclosures



GORTITE® ROLL UP DOORS

SAFE AND SECURE ACCESS FOR YOUR EQUIPMENT COMPARTMENTS

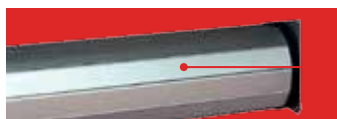

- Highest Quality Satin Anodized Finish or Painted with Basecoat and Clearcoat Process to Exactly Match your Vehicle
- 3" Diameter Take up Roller with Lifetime Warranty Allows for Maximum Compartment Storage
- Easily Replaceable Slats
- Stainless Steel Lift Bar

ROLL UP DOOR ACCESSORIES

SAFE AND SECURE ACCESS FOR YOUR EQUIPMENT COMPARTMENTS

MANUAL LOCK

- Choice of standard key codes
- Heavy duty version for large doors



POWER LOCK

- Compact design
- Manual override in the event of a power failure



MAGNETIC DOOR AJAR SWITCH

- Allows operator to know instantly if door is not securely closed

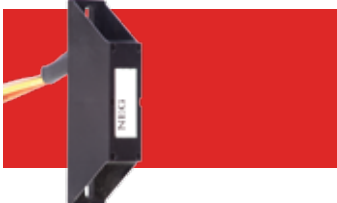

INSIDE OPENING HANDLE

- Simple, easy operation
- Exclusive Gortite® design



SEE-THROUGH SLATS

- Rugged polycarbonate material
- Ideal for exterior or interior compartments



LED COMPARTMENT LIGHTING

- Polycarbonate cover resists impact
- Water resistant



TECHNICAL INFORMATION

Internal Height	Minimum Depth	Header Height	Roll Up Diameter
up to 25"	10.000	2.500	5.375
26" to 35"	10.500	2.500	6.000
36" to 50"	11.500	2.500	6.000
51" to 60"	11.875	3.875	7.750
61" to 70"	12.375	4.250	8.250
71" to 90"	13.500	5.375	9.375
91" to 104"	14.125	6.500	10.500

Door Opening Width	Maximum Internal Height
18.000	30.000
19.000	40.000
20.000	56.000
21.000	60.00
22-27	90.000
28-32	100.000
33-78	110.000

Minimum header height is 2.500. Header heights shown can be used to better hide the rolled up door but are not necessarily required.

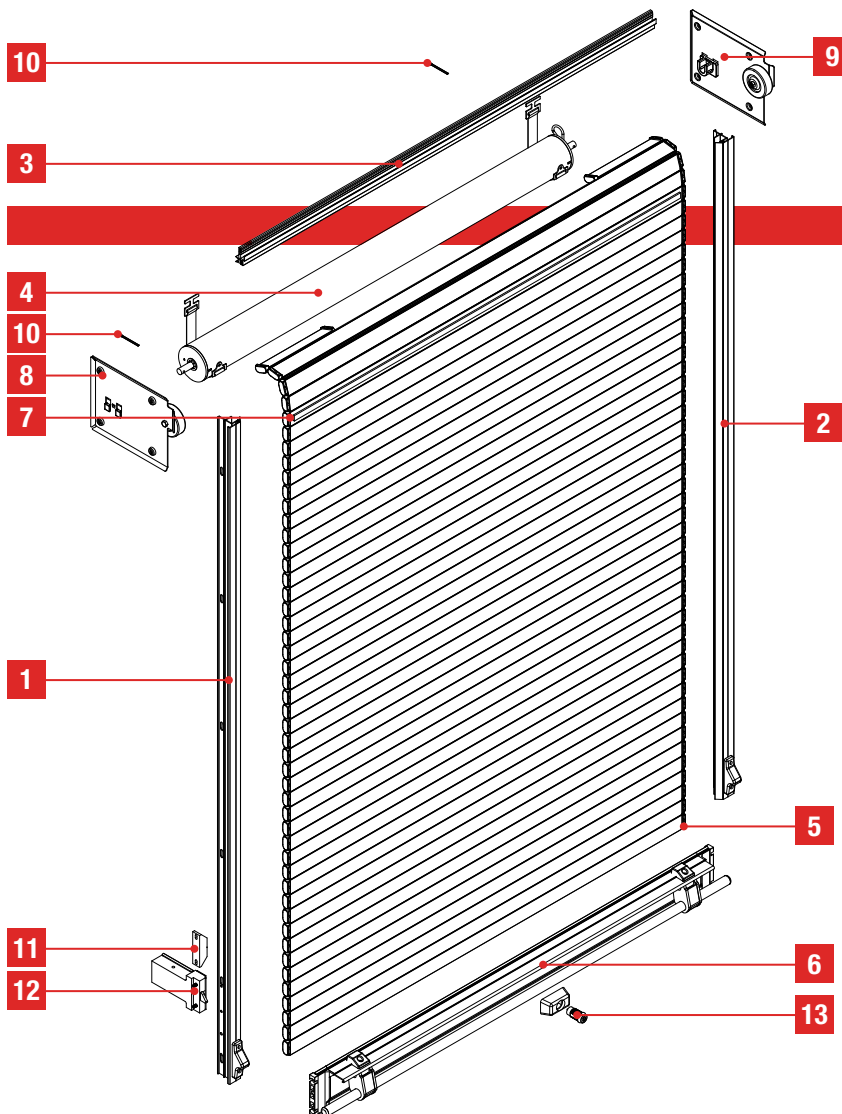

Description	Qty.
1 Side Rail, Left	1
2 Side Rail, Right	1
3 Top Rail	1
4 Roller	1
5 Shade	1
6 Handle Assembly	1
7 Door Seal Foam	1
8 Pennant Plate, Left	1
9 Pennant Plate, Right	1
10 Roller Pin	2
11 Door Ajar Switch	1
12 Power Door Lock	1
13 Manual Lock	1

GORTITE® ROLL UP DOORS

SPECIFICATION SHEET

Company _____

Contact _____

Telephone _____

Fax _____

Email Address _____

Website _____

Street Address _____

City, State, Zip _____

Reference _____

Quantity _____ Compartment: _____

Date Required _____

CABINET DIMENSIONS

Compartment									
DOW:									
DOH:									
HH:									
IH:									
CD:									

TOP VIEW

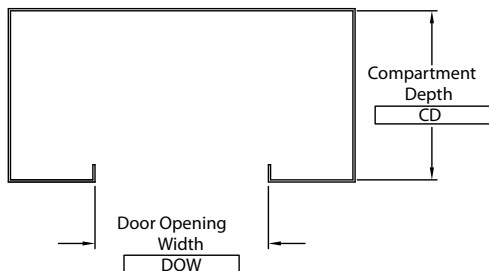

SIDE VIEW

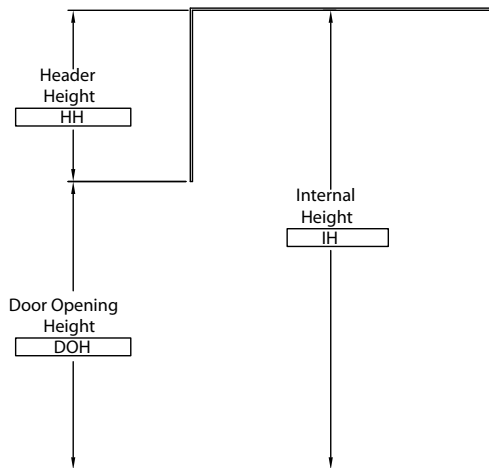

DOOR REQUIREMENTS

Door Finish

- ☐ Satin Anodized
- ☐ Mill Finish (for painting by customer)
- ☐ Wet Painted

- ☐ Door Only
- ☐ Door and Trim
- ☐ Handle/Finger Rail

Paint Specification: _____

Roller Location

- ☐ Front of Compartment
- ☐ Rear of Compartment

Side Rail

- ☐ Standard
- ☐ Recessed
- ☐ Universal
- ☐ P-Series
- ☐ R-Series

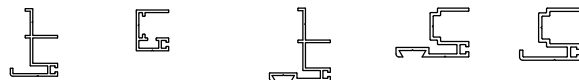

Pre-Drilled Mounting Holes in Side Rails

- ☐ Yes
 - ☐ Pattern by A&A
 - ☐ Pattern by Customer (please attach drawing)

Top Drip Rail

- ☐ Yes ☐ No
- ☐ Standard Length
- ☐ Custom Length
- Qty: _____ Length: _____

OPTIONS

Sill Plate

- ☐ Yes ☐ No
- ☐ Standard ☐ Universal

Manual Key Lock

- ☐ Yes ☐ No

Key Type

- ☐ J236
- ☐ 1250

Magnetic Door Ajar Switch

- ☐ Yes ☐ No
- ☐ Switch on Right Side Facing Door
- ☐ Switch on Left Side Facing Door
- ☐ Ship Loose
- Ground: ☐ Pos ☐ Neg

Pull Strap (for tall doors)

- ☐ Yes ☐ No

Power Lock (requires manual lock)

- ☐ Yes ☐ No
- ☐ Lock on Right Side of Door
- ☐ Lock on Left Side of Door
- ☐ Lock on Both Sides of Door (36" or wider)

Cabinet Lights

- ☐ Yes ☐ No
- ☐ Lights on Right Side of Door
- ☐ Lights on Left Side of Door
- ☐ Lights on Both Sides of Door
- ☐ Ship Loose

SO, HOW DO I SPECIFY GORTITE® ROLL UP DOORS? IT'S EASY

- 1 Roll Up Doors shall be Gortite® brand manufactured by A&A Manufacturing Co., Inc., New Berlin, WI.
- 2 Roll Up Doors to be constructed of double-sided aluminum extrusions. The extrusions are to be 1-3/8" wide and 3/8" thick with satin anodized finish or painted to match truck body.
- 3 A flexible extrusion shall be between each slat to insure a weather-tight seal.
- 4 Aluminum extrusions shall be individually replaceable without disassembling the entire door by removing push out clips on each end.
- 5 Side channels for the door to ride in shall be provided with seals to prevent dirt and moisture from entering compartment. A single piece top drip rail shall be provided with a seal to prevent dirt and moisture from entering the compartment when the door is fully closed. Bottom of door also be provided with a seal.
- 6 All non-metallic parts to be glass-filled nylon.
- 7 Lift bar shall be made of stainless steel.
- 8 The door shall be capable of operating in temperatures of -40°F to 180°F.
- 9 Optional accessories shall include a magnetic door ajar system, compartment lighting, manual key lock, power lock, sill plate and pull strap for tall doors.

OUR EXCLUSIVE GORTITE® ROLL UP DOOR WARRANTY

A&A Manufacturing Co., Inc. warrants its GORTITE® Roll Up Doors to be free from defects in materials and workmanship for a period of three years from the date of shipment.

The spring-loaded roller carries a lifetime warranty. All parts, with the exception of electronic equipment (which are warranted for 1 year) are covered under this warranty to the original owner. On painted doors, painted finish shall be warranted for five years from peeling or blistering. Damage due to accidents or external causes are not warranted.

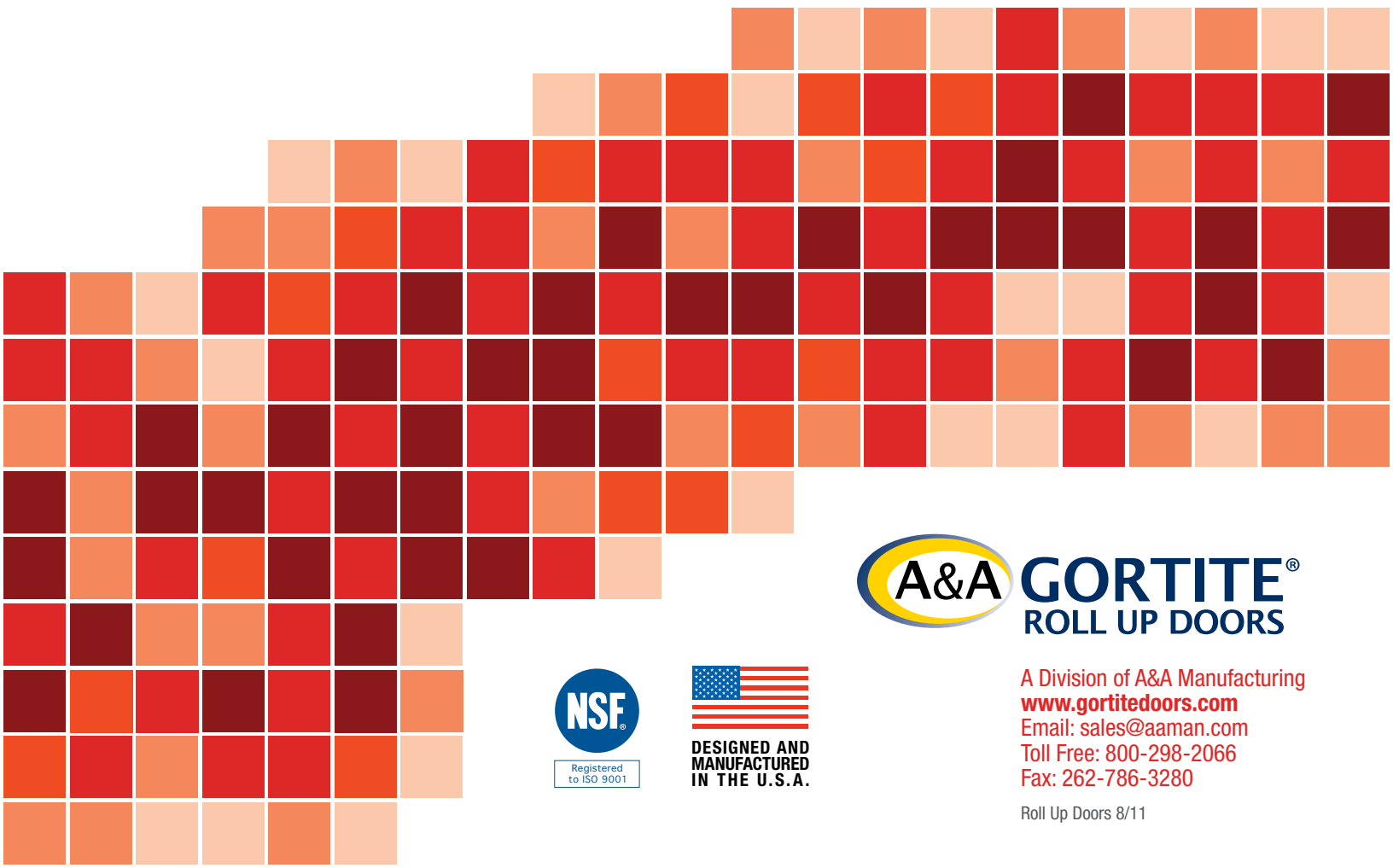

A Division of A&A Manufacturing
www.gortitedoors.com
Email: sales@aaman.com
Toll Free: 800-298-2066
Fax: 262-786-3280